

**Products designed with a purpose...**  
*...to help you help them.*



## Product Catalog

Safety Products · Syringes · Needles · I.V. Catheters · Insulin Syringes · Winged Infusion Sets · Micro-collection Products · Blood Pressure Monitor

# There's sharp. Then there's T-Sharp<sup>™</sup>

New study proves Terumo needles,  
on average, are sharpest among  
major needle brands tested.\*

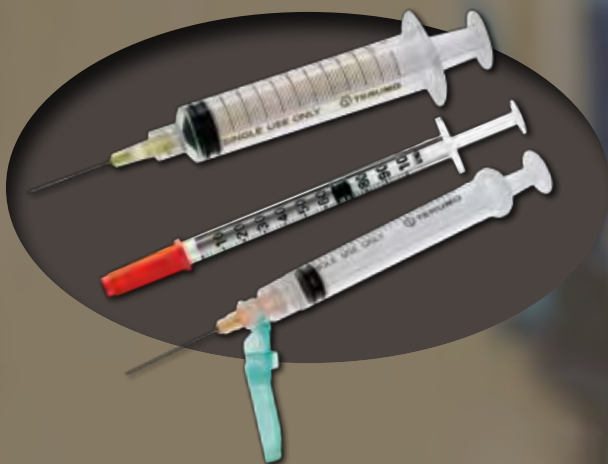

Terumo needle sharpness was compared to the leading competitors and, on average, was found to be sharper *in 85% of the direct product comparisons.*

Sharper needles provide patients with a more comfortable injection, thereby providing both patient and clinician with a more satisfying injection experience.

**When you think hypodermics...  
Think sharp. Think Terumo.**



T-SHARP<sup>™</sup> Technology is Terumo's proprietary manufacturing process that produces needles of superior sharpness.



## Table of Contents

### Blood Pressure Monitor

Elemano® Blood Pressure Monitor	4-5
---------------------------------	-----

### Hypodermics

SurGuard®2 Safety Needles	6
SurGuard®2 Syringes with Safety Needle	6
Terumo Hypodermic Needles	7
Dental Needles	7
Spinal Needles	7
Terumo Tuberculin Syringes	8
Terumo Hypodermic Syringes without Needle	8
Terumo Hypodermic Syringes with Needle	8
Pharmacy Trays	9
SurSaver® 1CC Syringe with Low Dead Space	9

### Insulin Syringes

Terumo Standard Insulin Syringes	10
----------------------------------	----

### Allergy Trays & Syringes

Terumo Standard Allergy Syringes & Allergy Trays	11
SurSaver® Mixing Syringes	11

### Safety IV Catheters

Surshield® Safety IV Catheters	12-13
--------------------------------	-------

### IV Catheters & Accessories

SURFLO® Teflon I.V. Catheters	14
SurFlash® Polyurethane I.V. Catheters	14
SURFLO® Injection Plugs	14

### Winged Needle Sets & Accessories

Surshield® Safety Winged Infusion Sets	15
SURFLO® Winged Infusion Sets	15
Surshield® Safety Blood Collection Sets	16
Venoject® Tube Holder	16
Multi-Sample Luer Adapter	16

### Micro-collection

Capiject® Safety Lancets	17
Capiject® Capillary Tubes	17

### Veterinary Products

Sur-Vet® Hypodermic Syringes	18
Sur-Vet® Hypodermic Needles	18
SURFLO® Teflon I.V. Catheters	18
SurFlash® Polyurethane I.V. Catheters	18
SURFLO® Winged Infusion Sets	18
SURFLO® Injection Plugs	18

# ***Elemano***<sup>®</sup>

## **Blood Pressure Monitor**

### **So Accurate. So Easy.**

The ELEMANO<sup>®</sup> Blood Pressure Monitor is the only monitor that combines gold standard accuracy with digital ease of use.

- Rapid BP and pulse readout in 30 seconds
- Accurate, automatic BP readout to  $\pm 3$  mmHg
- Encourages standardized measurements with multiple users
- No stethoscope required





## Blood Pressure Monitor



Basic set



XS/S/M/L cuffs available

## Specifications

<b>Measurement method</b>	Oscillometric (double cuff supported)	<b>Power supply</b>	Voltage: 1.5 V DC or 1.2 V DC
<b>Displayed measurements</b>	Systolic blood pressure, diastolic blood pressure, pulse rate (pulse waves)	<b>Operating conditions</b>	Temperature: 10 - 40°C; Humidity: 15 - 90% RH (no condensation)
<b>Measurement range</b>	Pressure: 0 - 320 mmHg (0 - 42.7kPa) Pulse rate: 30 - 199 beats/min	<b>Storage conditions</b>	Temperature: -20 - 60°C; Humidity: 10 - 95% RH (no condensation)
<b>Accuracy</b>	Pressure: $\pm 3$ mmHg ( $\pm 0.4$ kPa) Pulse rate: $\pm 5$	<b>Dimensions</b>	Main body: (w) 70 mm x (h) 46 mm x (d) 169 mm Cuff (size M): (w) 150 mm x (l) 520 mm
<b>Pressurization method</b>	Manual	<b>Weight</b>	Main body: 130g (excluding the battery) Cuff (size M): Approx. 150 g
<b>Decompression method</b>	Automatic	<b>Validation</b>	The Elemano was tested on 87 persons to compare its accuracy with that of the auscultatory method according to the AAMI SP-10 protocol. <sup>(1)</sup> The results prove that the Elemano fulfills the AAMI criteria.
<b>Measurement area</b>	Upper arm	<i>References: (1) Accuracy and applicability of the Terumo ES-H55 double-cuff sphygmomanometer for hospital use. Osamu Tochikubo, Kiyoko Nishijima, Kenji Ohshige and Kazuo Kimura - Blood Pressure Monitoring 2003, 8:203-209</i>	
<b>Warnings</b>	Insufficient and excessive pressurization, low battery		
<b>Errors</b>	Relevant error codes are displayed (Please consult IFU)		
<b>Automatic power off</b>	After 3 minutes without input on the operation panel		
<b>Number of measurements</b>	Provides about 1,000 measurements with a new AA alkaline cell when used continuously in the Normal Mode. (Refer to IFU)		

## Blood pressure monitor and accessories

To enable the right choice of cuff size and meet the hygiene requirements of a medical environment, Terumo offers a washable nylon cuff cover and four sizes (SS,S,M,L) to meet those requirements.

Product	Product Code
<b>Elemano blood pressure monitor</b> (includes Monitor, M-size nylon cuff, 2xbatteries, IFU)	ES*H5503
<b>Cuff</b> (washable nylon cuff cover plus air bag and tubing)	
Extra Small 13-20 cm (arm circumference)	XX*ES11SS06
Small 17-26 cm (arm circumference)	XX*ES11S06
Medium 24-32 cm (arm circumference)	XX*ES11M06
Large 32-42 cm (arm circumference)	XX*ES11L06

Product	Product Code
<b>Cuff Cover</b> (washable nylon cuff cover)	
Extra Small 13-20 cm (arm circumference)	XX*ES14SS06
Small 17-26 cm (arm circumference)	XX*ES14S06
Medium 24-32 cm (arm circumference)	XX*ES14M06
Large 32-42 cm (arm circumference)	XX*ES14L06
<b>Inflation bulb</b>	XX*ES1802
<b>Storage bag</b>	XX*ES1702
<b>Accuracy check parts</b>	XX*ES1602

## Safety Hypodermics

Terumo® is a worldwide leader in the design, manufacture, and marketing of hypodermic syringes and needles.

- Unique needle locking mechanism to help reduce the risk of needlestick injury
- An audible click\* indicates device activation
- One-handed activation for ease of use
- Sleek, thin, streamlined sheath
- Bevel-up, sheath right orientation, especially useful for low-angle injections
- Ratchet mechanism, allows for precise positioning of sheath so as not to obscure injection site
- Standard hub fits all luer lock and luer slip syringes

\* NOTE: Audible click may not be heard on small needle sizes; visual confirmation is required.



...Safety in a Single-Handed,  
Easy to Use Design...



(Large Photo)

### SurGuard®2 Safety Needle

Packed: 100/box, 8 boxes/case (800)

Product Code	Description
SG2-1825	18G x 1" needle
SG2-1838	18G x 1½" needle
SG2-1925	19G x 1" needle
SG2-1938	19G x 1½" needle
SG2-2025	20G x 1" needle
SG2-2038	20G x 1½" needle
SG2-2125	21G x 1" needle
SG2-2138	21G x 1½" needle
SG2-2225	22G x 1" needle
SG2-2238	22G x 1½" needle
SG2-2325	23G x 1" needle
SG2-2338	23G x 1½" needle
SG2-2516	25G x ⅝" needle
SG2-2525	25G x 1" needle
SG2-2538	25G x 1½" needle
SG2-2613	26G x ½" needle
SG2-2713	27G x ½" needle
SG2-3013	30G x ½" needle

### SurGuard®2 Syringe with Safety Needle

Packed: 100/box, 4 boxes/case (400)

#### 1CC Syringes

Product Code	Description
SG2-01T2516	25G x ⅝" needle
SG2-01T2609	26G x ⅜" needle
SG2-01T2713	27G x ½" needle

#### 3CC Syringes

Product Code	Description
SG2-03L2025	20G x 1" needle
SG2-03L2038	20G x 1½" needle
SG2-03L2125	21G x 1" needle
SG2-03L2138	21G x 1½" needle
SG2-03L2225	22G x 1" needle
SG2-03L2238	22G x 1½" needle
SG2-03L2325	23G x 1" needle
SG2-03L2516	25G x ⅝" needle
SG2-03L2525	25G x 1" needle

#### 5CC Syringes

Product Code	Description
SG2-05L2025	20G x 1" needle
SG2-05L2038	20G x 1½" needle
SG2-05L2138	21G x 1½" needle

#### 10CC Syringes

Product Code	Description
SG2-10L2025	20G x 1" needle
SG2-10L2038	20G x 1½" needle
SG2-10L2125	21G x 1" needle

## Conventional Needles

LATEX FREE



## Dental Needles

TERUMO Dental Needles are latex free and are available in both short and long sizes for conduction anesthesia and infiltration anesthesia. The ultra-sharp needle minimizes pain and discomfort.

**Packed: 100/box, 20 boxes/case (2,000)**

Product Code	Description
DN*2530K	25G x 1 3/16" long needle
DN*2721K	27G x 13/16" short needle
DN*2730K	27G x 1 3/16" long needle
DN*3021K	30G x 13/16" short needle



## Spinal Needles

The TERUMO Spinal Needle tip is beveled for smoother penetration. The blister pack's peel-apart feature allows you to dispense the needle into a sterile field. Color-coding is used on the stylet-hub, blister pack, and shelf package for rapid gauge identification at every stage.

**Packed: 20/box, 10 boxes/case (200)**

Product Code	Description
SN*1890	18G x 3 1/2" needle
SN*2070	20G x 2 3/4" needle
SN*2090	20G x 3 1/2" needle
SN*2270	22G x 2 3/4" needle
SN*2290	22G x 3 1/2" needle
SN*2590	25G x 3 1/2" needle



## Terumo® Standard Hypodermic Needles

**Packed: 100/box, 10 boxes/case (1,000)**

Product Code	Description
NN-1825R	18G x 1" TW
NN-1838R	18G x 1 1/2" TW
NN-1925R	19G x 1" TW
NN-1938R	19G x 1 1/2" TW
NN-2025R	20G x 1" UTW
NN-2038R	20G x 1 1/2" UTW
NN-2125R	21G x 1" UTW
NN-2138R	21G x 1 1/2" UTW
NN-2225R	22G x 1" UTW
NN-2238R	22G x 1 1/2" UTW
NN-2325R	23G x 1" UTW
NN-2338R	23G x 1 1/2" UTW
NN-2516R	25G x 5/8" UTW
NN-2525R	25G x 1" UTW
NN-2538R	25G x 1 1/2" RW
NN-2613R	26G x 1/2" RW
NN-2713R	27G x 1/2" RW
NN-3013R	30G x 1/2" RW

RW - Regular Wall  
TW - Thin Wall  
UTW - Ultra Thin Wall

## Conventional Syringes

### 1cc Tuberculin Syringes

**Graduations: 0.01cc (1cc total)**

TERUMO TB Syringes have clear, bold scale markings which assure dosage control and accuracy. The package is tamper evident, for greater protection of the sterile contents.

**Packed: 100/box, 10 boxes/case (1,000)**

Product Code	Description
SS-01T	1cc TB Syringe without needle, with luer slip
SS-01T2516	1cc TB Syringe with 25G x 5/8" removable needle
SS-01T2609	1cc TB Syringe with 26G x 3/8" removable needle
SS-01T2713	1cc TB Syringe with 27G x 1/2" removable needle



Catheter Tip

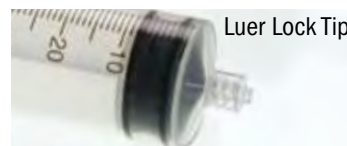

Luer Lock Tip



Eccentric Luer Tip

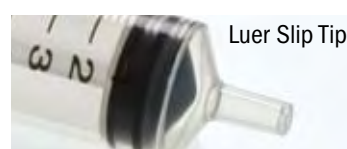

Luer Slip Tip

### 3cc Syringes with Needle

**Style: Luer Lock Tip**

**Graduations: 0.1cc (3cc total)**

**Packed: 100/box, 10 boxes/case (1,000)**

Product Code	Description
SS-03L2025	3cc, 20G x 1" UTW
SS-03L2038	3cc, 20G x 1 1/2" UTW
SS-03L2125	3cc, 21G x 1" UTW
SS-03L2138	3cc, 21G x 1 1/2" UTW
SS-03L2225	3cc, 22G x 1" UTW
SS-03L2238	3cc, 22G x 1 1/2" UTW
SS-03L2325	3cc, 23G x 1" UTW
SS-03L2338	3cc, 23G x 1 1/2" UTW
SS-03L2516	3cc, 25G x 5/8" UTW
SS-03L2525	3cc, 25G x 1" UTW

### 5cc Syringes with Needle

**Style: Luer Lock Tip**

**Graduations: 0.2cc (6cc total)**

**Packed: 100/box, 6 boxes/case (600)**

Product Code	Description
SS-05L2025	5cc, 20G x 1" UTW
SS-05L2038	5cc, 20G x 1 1/2" UTW
SS-05L2125	5cc, 21G x 1" UTW
SS-05L2138	5cc, 21G x 1 1/2" UTW
SS-05L2225	5cc, 22G x 1" UTW
SS-05L2238	5cc, 22G x 1 1/2" UTW

### 10cc Syringes with Needle

**Style: Luer Lock Tip**

**Graduations: 0.2cc (12cc total)**

**Packed: 100/box, 6 boxes/case (600)**

Product Code	Description
SS-10L2025	10cc, 20G x 1" UTW
SS-10L2038	10cc, 20G x 1 1/2" UTW
SS-10L2125	10cc, 21G x 1" UTW
SS-10L2138	10cc, 21G x 1 1/2" UTW
SS-10L2238	10cc, 22G x 1 1/2" UTW

UTW - Ultra Thin Wall

### 3cc Syringes without Needle

**Graduations: 0.1cc (3cc total)**

**Packed: 100/box, 10 boxes/case (1,000)**

Product Code	Description
SS-03L	Luer Lock Tip
SS-03S	Luer Slip Tip

### 5cc Syringes without Needle

**Graduations: 0.2cc (6cc total)**

**Packed: 100/box, 6 boxes/case (600)**

Product Code	Description
SS-05L	5cc Luer Lock Tip
SS-05S	5cc Luer Slip Tip

### 10cc Syringes without Needle

**Graduations: 0.2cc (12cc total)**

**Packed: 100/box, 6 boxes/case (600)**

Product Code	Description
SS-10L	10cc Luer Lock Tip
SS-10S	10cc Slip Tip
SS-10ES	10cc Eccentric Luer Tip

### 20cc Syringes without Needle

**Graduations: 1.0cc (25cc total)**

**Packed: 50/box, 4 boxes/case (200)**

Product Code	Description
SS-20L2	20cc Luer Lock Tip
SS-20S2	20cc Luer Slip Tip
SS-20ES2	20cc Eccentric Luer Tip

### 30cc Syringes without Needle

**Graduations: 1.0cc (35cc total)**

**Packed: 25/box, 8 boxes/case (200)**

Product Code	Description
SS-30L	30cc Luer Lock Tip
SS-30S	30cc Luer Slip Tip
SS-30ES	30cc Eccentric Luer Tip

### 60cc Syringes without Needle

**Graduations: 1.0cc (60cc total)**

**Packed: 25/box, 4 boxes/case (100)**

Product Code	Description
SS-60L	60cc Luer Lock Tip
SS-60ES	60cc Eccentric Luer Tip
SS-60C	60cc 2oz. Catheter Tip





## Comfort

Terumo pioneered many of today's most important hypodermic features such as ultra clear barrels, latex free syringes, and an integrated plunger stop which helps prevent the plunger from being accidentally pulled out.

Terumo's Hypodermic needles use a unique double bevel design and precision manufacturing to provide ultra sharp needles, which translate into greater comfort for the patient.

Terumo's Research & Development continues to investigate and develop new features that provide the patient with greater comfort, the clinician with safer and easier to use products, and the medical facility with efficacious and cost effective hypodermic products.

### Pharmacy Trays

All Luer Lock Tip without Syringe Tip Cap

Product Code	Description
SS10LT	10cc, (12cc total) Packed: 25 syringes/tray, 8 trays/case (200)
SS20LT	20cc, (25cc total) Packed: 25 syringes/tray, 8 trays/case (200)
SS30LT	30cc, (35cc total) Packed: 10 syringes/tray, 12 trays/ case (120)
SS60LT	60cc (60cc total) Packed: 10 syringes/tray, 12 trays/case (120)

### SurSaver® 1CC Syringe with Low Dead Space

SurSaver® 1CC syringes are designed with a permanently attached needle which eliminates the needle hub. This design greatly reduces dead space as compared to standard syringes. The needle hub on standard syringes traps drugs that are not expelled after injection. Over the course of one year, these accumulated, "wasted" drugs can represent a significant cost to your facility.

**1cc syringe with fixed needle**

**Packed: 100/box, 5 boxes/case (500)**

Product Code	Description
SS01D2313	23G x 1/2"
SS01D2516	25G x 5/8"
SS01D2713	27G x 1/2"



## Insulin

# Insulin

Our full line of insulin syringes offer patients with diabetes comfort and accuracy for their daily self-injections.

- Unsurpassed needle sharpness and smooth plunger movement help make injections more comfortable
- Bold, clear scale markings help ensure accurate dosing
- A wide range of sizes, including 31G, our smallest needle available

LATEX FREE

### Terumo Standard Insulin Syringes

Low Dead Space design, for use with U-100 insulin only, with attached needle. Based on extreme needle sharpness and smooth plunger movement, TERUMO® Insulin syringes are designed for maximum comfort. Clear, bold scale markings assure dosage control and accuracy.

**Packed: 100/box, 5 boxes/case (500)**

Product Code	Description (All Insulin Syringe)
SS05M2713	½ cc, 27G x ½" Graduations: 0.01cc, 1 unit of insulin
SS05M2813	½ cc, 28G x ½" Graduations: 0.01cc, 1 unit of insulin
SS05M2913	½ cc, 29G x ½" Graduations: 0.01cc, 1 unit of insulin
SS05M3009	½ cc, 30G x ⅜" Graduations: 0.01cc, 1 unit of insulin
SS05M3109	½ cc, 31G x ⅜" Graduations: 0.01cc, 1 unit of insulin
SS10M2713	1 cc, 27G x ½" Graduations: 0.02cc, 2 units of insulin
SS10M2813	1 cc, 28G x ½" Graduations: 0.02cc, 2 units of insulin
SS10M2913	1 cc, 29G x ½" attached needle, Graduations: 0.02cc, 2 units of insulin
SS10M3009	1 cc, 30G x ⅜" attached needle, Graduations: 0.01cc, 1 unit of insulin
SS10M3109	1 cc, 31G x ⅜" attached needle, Graduations: 0.02cc, 2 units of insulin
SS30M2913	¾ cc, 29G x ½" attached needle, Graduations: 0.01cc, 1 unit of insulin
SS30M3009	¾ cc, 30G x ⅜" attached needle, Graduations: 0.01cc, 1 unit of insulin
SS30M3109	¾ cc, 31G x ⅜" attached needle, Graduations: 0.005cc, ½ unit of insulin



## Allergy Trays and Syringes

## Terumo Standard Allergy Trays & Allergy Syringes

TERUMO Allergy Syringes are packaged in trays of 25 pieces and have low dead space for maximum cost savings. The barrel is clear and easy to read. Sharp needles minimize patient discomfort.

**Allergy Syringe Trays Packed: 25 syringes/tray, 40 trays/case (1,000)**

Product Code	Description
SS01A2609T	1cc with 26G x $\frac{3}{8}$ " regular bevel needle
SS01A2713T	1cc with 27G x $\frac{1}{2}$ " regular bevel needle
SS10A2709IDT	1cc with 27G x $\frac{3}{8}$ " intradermal bevel needle for skin testing
SS10A2713IDT	1cc with 27G x $\frac{1}{2}$ " intradermal bevel needle for skin testing

**Allergy Syringes Packed: 100/box, 5 boxes/case (500)**

SS01A2713	1cc Single Allergy Syringe with 27G x $\frac{1}{2}$ " regular bevel needle, individually packed, Graduations: 0.01cc (1cc total)
-----------	--



## Allergy

Terumo offers a wide variety of standard allergy syringes. They are packaged in convenient trays of 25 syringes/tray.

The allergy syringes have very clear barrels for easy visualization of air bubbles and proper dosing. Scale markings are bold, crisp and easy to read. Terumo's syringes are latex free and are available with regular and intradermal bevel needles to meet all your needs. The smooth plunger action helps provide better control during administration and our extremely sharp needles help minimize patient discomfort.

## SurSaver® Mixing Syringes:

- Easy to draw up viscous allergenic extracts
- Only 0.0021 mL dead space minimizes antigen waste
- Smooth plunger
- Clear barrel
- Easy to read scale markings
- Ultra-sharp needle

### SurSaver® Mixing Syringe Trays

**Packed: 25/tray, 40 trays/case (1,000)**

Product Code	Description
SS01A2313T	1cc with 23G x $\frac{1}{2}$ " regular bevel needle, tray

### SurSaver® Mixing Syringes Individually Packed

**Packed: 100/box, 5 boxes/case (500)**

Product Code	Description
SS01D2313	1cc with 23G x $\frac{1}{2}$ " regular bevel needle, individually packed





**My patients rely on me.**

**That's why I rely on Surshield<sup>®</sup>,  
the *Sure* sign of first-stick success**

**Terumo's innovative I.V. catheter is the only one with SurFlash<sup>®</sup>, our exclusive catheter placement indicator, plus a passive safety feature.**

- First-stick success: 14% to 25% improvement\*
- Passive safety: No extra steps required
- Easy to use: Ultrasharp, double bevel needle and medical-grade lubricant for smoother venipuncture

**For more information, visit our website [www.surshieldIV.com](http://www.surshieldIV.com)**

\*Data on file





# Surshield® Safety IV Catheter

## Accurate catheterization... superior safety.

### SurFlash® enhanced flashback feature for clear visual confirmation of accurate catheter placement

- Increased first-stick success – even in challenging venipuncture situations
- Reduced risk of vein injury
- Fewer wasted catheters
- Enhanced confidence in performing venipuncture
- Improved patient satisfaction

### Passive needle safety

- Reduced risk of needlestick injury
- Easy to use
- Automatic activation – no extra steps needed

### Ultra-sharp, double-bevel needle with medical-grade lubricant

- Easy insertion and smooth catheter advancement
- Smooth venipuncture

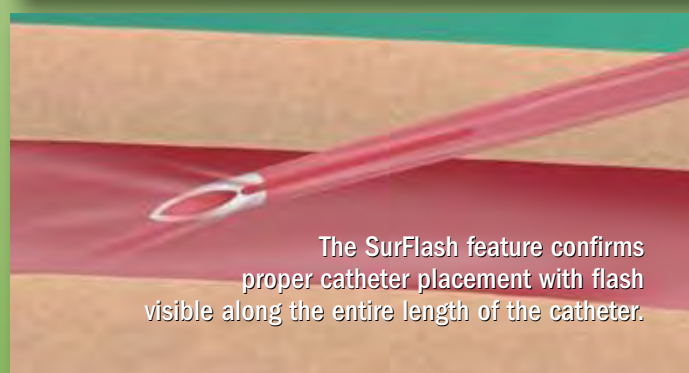
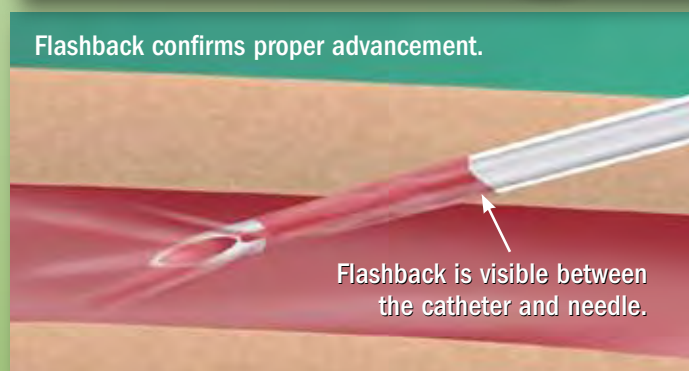
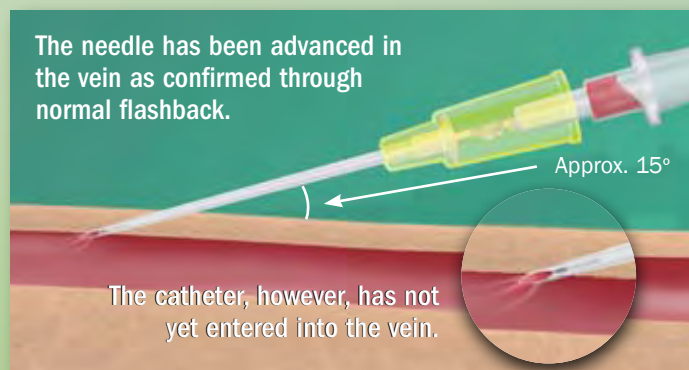

NOTE: The needle insertion angle in the illustrations differs from actual insertion angle.

### Clinically Proven

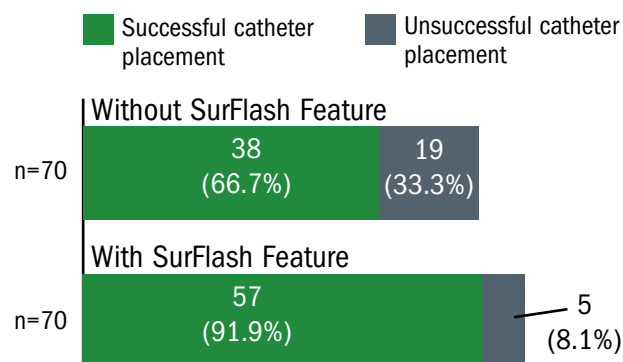

P<0.01 significant difference

Ohu University Dental Hospital Journal, Vol. 28 (1); 27-31, 2001 (20 gauge data)

### Surshield Safety I.V. Catheters

Packed: 50 per box, 4 boxes per case (200)

Product Code	Description
SR*SFA1832A	18G x 1 1/4" (Green)
SR*SFA1851A	18G x 2" (Green)
SR*SFA2032A	20G x 1 1/4" (Pink)
SR*SFA2051A	20G x 2" (Pink)
SR*SFA2232A	22G x 1 1/4" (Blue)
SR*SFA2225A	22G x 1" (Blue)
SR*SFA2419A	24G x 3/4" (Yellow)

**NEW!**

**NEW!**

**NEW!**

## I.V. Catheters & Accessories

LATEX FREE



(Large Photo)

### **SURFLO® Teflon I.V. Catheters**

An ultra-sharp double-bevel introducer needle plus a medical grade lubricant allow for easier penetration and smoother travel through tissue. Preview chamber in clear sure-grip hub gives immediate indication of proper placement. Flexible thinwall catheter with large inner diameter assures good blood flow. All this plus safe, easy-to-handle, tamper-evident packaging make SURFLO® I.V. Catheters a great clinical value.

**Packed: 50/box, 4 boxes/case (200)**

Product Code	Description
SR-OX1451CA	14G x 2"
SR-OX1632CA	16G x 1 1/4"
SR-OX1651CA	16G x 2"
SR-OX1664CA	16G x 2 1/2"
SR-OX1832CA	18G x 1 1/4"
SR-OX1851CA	18G x 2"
SR-OX1864CA	18G x 2 1/2"
SR-OX2025CA	20G x 1"
SR-OX2032CA	20G x 1 1/4"
SR-OX2051CA	20G x 2"
SR-OX2225CA	22G x 1"
SR-OX2419CA	24G x 3/4"

(Not Pictured)

### **SurFlash® Polyurethane I.V. Catheters**

- Visual confirmation of catheter placement during venipuncture occurs in a flash!
- Made of polyurethane, which makes it extremely flexible, kink-resistant and durable
- Provides medical staff with higher certainty of catheter placement due to unique flashback feature
- Improves visualization for difficult venipunctures

**Packed: 50/box, 4 boxes/case (200)**

Product Code	Description
SR*FF1451	14G x 2"
SR*FF1651	16G x 2"
SR*FF1664	16G x 2 1/2"
SR*FF1832	18G x 1 1/4"
SR*FF1851	18G x 2"
SR*FF1864	18G x 2 1/2"
SR*FF2025	20G x 1"
SR*FF2032	20G x 1 1/4"
SR*FF2051	20G x 2"
SR*FF2225	22G x 1"
SR*FF2419	24G x 3/4"



**Terumo's Polyurethane I.V. Catheter enables quick and easy confirmation of placement in the vein.**

With SurFlash, visual confirmation of catheter placement occurs due to a unique flashback feature. Flashback appears between the specially grooved needle and the catheter, providing medical staff with a higher certainty of proper catheter placement. The specially grooved needle also improves the ability to visualize flashback in patients where venipuncture is more difficult, and because SurFlash is made of polyurethane, which is firm at room temperature and softens at body temperature, patient comfort is enhanced, without compromising proper technique.



### **SURFLO® Injection Plug**

SURFLO Injection Plugs come in a choice of Luer Lock or Luer Slip. Large target area allows for easy needle penetration. The injection plugs have a tamper-resistant seal and easy to open packaging.

**Packed: 100/box, 10 boxes/case (1,000)**

Product Code	Description
SR-IP1	Luer Slip Injection Plug Luer Taper is 1.5 inches
SR-IP2	Luer Lock Injection Plug Luer Lock is 1.0 inches

## Winged Infusion Sets

LATEX FREE



(Large Photo)

**SURFLO® Winged Infusion Sets****Product Code    Description****(3½" Tubing)****Packed: 100/box, 5 boxes/case (500)**

SV*19BLS	19G x ¾" TW
SV*21BLS	21G x ¾" UTW
SV*23BLS	23G x ¾" UTW
SV*25BLS	25G x ¾" TW

**(Intermittent Plug, 3½" Tubing)****Packed: 100/box, 5 boxes/case (500)**

SV*19BI	19G x ¾" TW
SV*21BI	21G x ¾" UTW
SV*23BI	23G x ¾" UTW

**(8" Tubing)****Packed: 100/box, 10 boxes/case (1,000)**

SV*25EL	25G x ½" RW
SV*27EL	27G x ½" RW

**(12" Tubing)****Packed: 50/box, 10 boxes/case (500)**

SV-18BLK	18G x ¾" TW
SV-19BLK	19G x ¾" TW
SV-21BLK	21G x ¾" UTW
SV-22BLK	22G x ¾" UTW
SV-23BLK	23G x ¾" UTW
SV-25BLK	25G x ¾" TW

**Surshield® Safety  
Winged Infusion Sets****Packed: 50/box, 10 boxes/case (500)****Product Code    Description****(3½" Tubing)**

SV*S19BLS	19G x ¾" needle
SV*S21BLS	21G x ¾" needle
SV*S23BLS	23G x ¾" needle
SV*S25BLS	25G x ¾" needle

**(12" Tubing)**

SV*S19BL	19G x ¾" needle
SV*S21BL	21G x ¾" needle
SV*S23BL	23G x ¾" needle
SV*S25BL	25G x ¾" needle

RW - Regular Wall  
TW - Thin Wall  
UTW - Ultra Thin Wall

"Surshield® has been a great product for us. The Surshield is easy to use – you simply flip the shield over the needle."

— Joe Barber  
Laboratory Manager

## Blood Collection Sets

# Safety

Terumo's Surshield Safety Winged Needle Sets with one-handed activation provides a solution with a cost-effective, easy to use design. Press shield over the needle until it locks into place.

- Unique needle locking mechanism helps reduce the risk of needlestick injuries
- One-handed activation for safety and ease of use
- No change in needle insertion technique
- Simple, built-in safety design is easy to use

1. Flip safety shield toward needle.  
Remove the needle and apply digital pressure to the site.

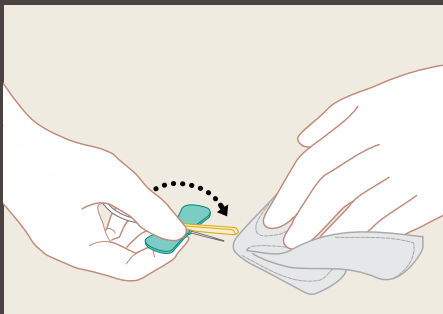

2. With the wing and shield between your thumb and index finger, press the safety shield against a hard surface such as a bedside table until an audible click is heard.

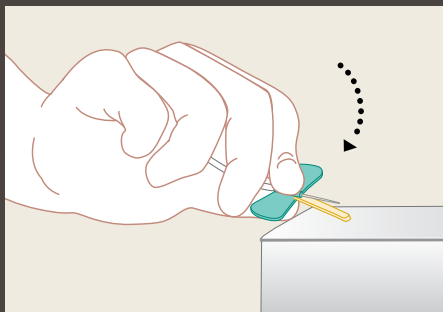

3. Visually confirm activation of the safety feature. (10/08)



LATEX FREE



(Large Photo)

### Surshield® Safety Blood Collection Sets

Packed: 50/box, 10 boxes/case (500)



#### Product Code Description

##### (12" Tubing)

MN*SVS21B30	21G x 3/4" needle
MN*SVS23B30	23G x 3/4" needle
MN*SVS25B30	25G x 3/4" needle

##### (7" Tubing)

MN*SVS21B18	21G x 3/4" needle
MN*SVS23B18	23G x 3/4" needle

### Venoject® Tube Holder

Standard Tube Holder compatible with most blood collection needles.

Packed: 50/bag, 20 bags/case (1,000)

#### Product Code Description

P-1316R	VENOJECT II (Standard) Tube Holder. Use with the multi-sample luer adapter and Diversion Blood Sampling Arm® and Blood Sampling Arm blood bags to collect samples.
---------	--

LATEX FREE



### Multi-Sample Luer Adapter

Sterile and disposable, adapters fit into standard infusion sets transforming them into winged blood collection sets. This allows multiple draws into evacuated tubes. Accepts standard tube holders.

Packed: 100/box, 30 boxes/case (3,000)

#### Product Code Description

MN*2000T	VENOJECT® Multi-Sample Luer Adapter (male). For use with Standard Tube Holder and SampLok® Tube Holder.
----------	---

LATEX FREE





### Capiject Safety Lancets

High quality, single-use lancets offer the form, fit and function you've come to rely on

- **Never see or handle the sharp:**  
Automatic blade or needle retraction styles - the sharp edge is enclosed before and after use
- **No special staging required:**  
Ready to use right out of the box
- **One-step activation:**  
Convenient activation for precise and consistent results
- **Color-coded sizes:**  
Quick identification of the right product

**Packed: 200/box, 10 boxes/case (2,000)**



LATEX FREE

Catalog Number	Color	Description	Width/Gauge	Depth
200101	Pink	Blade	1.5mm	1.0mm
200102	Green	Blade	1.5mm	1.5mm
200103	Blue	Blade	1.5mm	2.0mm
200104	Orange	Needle	23G	2.25mm
200105	Purple	Needle	28G	1.25mm



“Capiject® is preferred by our specimen collectors, is a better fit for our centrifuges and gives us quality plasma separation in an amber tube.”

— James E. Dillard, BS, MT(ASCP)  
Supervisor, Clinical Chemistry

### Capiject Capillary Tubes

- Extra-wide, built-in collection lip for enhanced specimen flow
- Single piece, tapered design for easy collection and handling
- Color-coded fill lines and caps for volume accuracy and easy identification
- Lot number and expiration date printed on each tube for easy identification
- Silicone-coated anticoagulant tubes designed to reduce clotting
- Olefin-based gel for clean separations
- Tube nests in cap allowing tube to stand alone
- Certified for lead testing
- Latex free

**Packed: 50/bag, 5 bags/box, 4 boxes/case (1,000)**

FOR IN VITRO DIAGNOSTIC USE

Catalog Number	Tube Color	Tube additive	Application	Lead Testing Certified	Fill Volume µL
T-MG	Cherry Red	Gel Barrier with clot activator (silica particles and inert gel)	Serum determinations in clinical chemistry	X	500
T-MQK	Lavender	K2-EDTA (0.78 mg)	Whole blood hematology procedure	X	500
T-M	Brick Red	No Additive/Clot Tube	Serum determinations in clinical chemistry, serology and blood banking	X	500
T-MLH	Green	Lithium Heparin (12.5 IU)	Plasma determinations in clinical chemistry	X	500
T-MLHG	Mint Green	Lithium Heparin with Gel (12.5 IU)	Plasma determinations in clinical chemistry	X	500
T-MLHGA	Mint Green	Amber tube with Lithium Heparin and gel barrier (12.5 IU)	Light-sensitive plasma determinations in clinical chemistry	X	500
T-MPS	Gray	Sodium Fluoride (0.72 mg) Potassium Oxalate (0.58 mg)	Glucose determinations	X	250
T-MGA	Gold	Amber tube with gel barrier and clot activator (silica particles and inert gel)	Light-sensitive serum analyte determinations (Bilirubin determinations)	X	500

## Veterinary Products

LATEX FREE



The Terumo Sur-Vet® Needle...  
“Felt like it was passing through  
cotton fabric – smooth.”

— Vicki Stuessi,  
Pet Owner

### Sur-Vet Hypodermic Needle

Packed: 100/box, 10 boxes/case (1,000)

Product Code	Description
100204	20G x 1" RW
100215	22G x 3/4" RW
100211	22G x 1" RW
100220	25G x 5/8" RW
100279	22G x 3/4" UTW
100280	25G x 5/8" UTW

RW - Regular Wall  
TW - Thin Wall  
UTW - Ultra Thin Wall

### Sur-Vet Hypodermic Syringe with Needle

Packed: 100/box, 10 boxes/case (1,000)

Product Code	Description
100090	3cc syringe with 20G x 1", Graduations: 0.1cc (3cc total)
100097	3cc syringe with 22G x 3/4", Graduations: 0.1cc (3cc total)
100098	3cc syringe with 22G x 1", Graduations: 0.1cc (3cc total)
100103	3cc syringe with 25G x 5/8", Graduations: 0.1cc (3cc total)
100276	3cc syringe with 22G x 3/4", Graduations: 0.1cc (3cc total)
100277	3cc 22G x 1", Graduations: 0.1cc (3cc total)
100278	3cc with 25G x 5/8", Graduations: 0.1cc (3cc total)
100281	1cc Luer Slip Tip TB Syringe with 25G x 5/8" removable needle, Low Dead Space, Graduations: 0.01cc (1cc total)

### SURFLO® Teflon I.V. Catheters

Packed: 50/box, 4 boxes/case (200)

Product Code	Description
SR-OX1451CA	14G x 2"
SR-OX1632CA	16G x 1 1/4"
SR-OX1651CA	16G x 2"
SR-OX1664CA	16G x 2 1/2"
SR-OX1832CA	18G x 1 1/4"
SR-OX1851CA	18G x 2"
SR-OX1864CA	18G x 2 1/2"
SR-OX2025CA	20G x 1"
SR-OX2032CA	20G x 1 1/4"
SR-OX2051CA	20G x 2"
SR-OX2225CA	22G x 1"
SR-OX2419CA	24G x 3/4"

### SurFlash® Polyurethane I.V. Catheters

Packed: 50/box, 4 boxes/case (200)

Product Code	Description
SR*FF1451	14G x 2"
SR*FF1651	16G x 2"
SR*FF1664	16G x 2 1/2"
SR*FF1832	18G x 1 1/4"
SR*FF1851	18G x 2"
SR*FF1864	18G x 2 1/2"
SR*FF2025	20G x 1"
SR*FF2032	20G x 1 1/4"
SR*FF2051	20G x 2"
SR*FF2225	22G x 1"
SR*FF2419	24G x 3/4"

### SURFLO Injection Plugs

Packed: 100/box, 10 boxes/case (1,000)

Product Code	Description
SR-IP1	Luer Slip Injection Plug Luer Taper is 1.5 inches
SR-IP2	Luer Lock Injection Plug Luer Lock is 1.0 inches

### SURFLO® Winged Infusion Sets

Product Code Description  
(3 1/2" Tubing)

SV*19BLS	19G x 3/4" TW
SV*21BLS	21G x 3/4" UTW
SV*23BLS	23G x 3/4" UTW
SV*25BLS	25G x 3/4" TW

Packed: 100/box, 5 boxes/case (500)

(Intermittent Plug, 3 1/2" Tubing)

SV*19BI	19G x 3/4" TW
SV*21BI	21G x 3/4" UTW
SV*23BI	23G x 3/4" UTW

Packed: 100/box, 5 boxes/case (500)

(8" Tubing)

SV*25EL	25G x 1 1/2" RW
SV*27EL	27G x 1 1/2" RW

Packed: 100/box, 10 boxes/case (1,000)

(12" Tubing)

SV-18BLK	18G x 3/4" TW
SV-19BLK	19G x 3/4" TW
SV-21BLK	21G x 3/4" UTW
SV-22BLK	22G x 3/4" UTW
SV-23BLK	23G x 3/4" UTW
SV-25BLK	25G x 3/4" TW

Packed: 50/box, 10 boxes/case (500)



## Frequently Asked Questions and Technical Support

### Who is the Sales Rep for my area?

Just log-on to [www.TerumoTMP.com](http://www.TerumoTMP.com) and select "Find Your Rep" from our homepage.

### How can I order Terumo products through a distributor?

Please see Terumo website: [www.TerumoTMP.com](http://www.TerumoTMP.com), and click on Customer Support to find a List of Authorized Terumo distributors.

### How can I obtain samples?

Need samples? We've now made it faster and easier for you to obtain samples and literature of our products through your local TMP rep. Just log-on to [www.TerumoTMP.com](http://www.TerumoTMP.com) and select "Find Your Rep" from our homepage.

### How can I obtain pricing?

You must check with your local distributor for pricing since our business is conducted through authorized distributors.

### How do I place an order?

Please contact your authorized distributor.  
To find a distributor, visit us at [www.TerumoTMP.com/Support](http://www.TerumoTMP.com/Support) to find a List of Authorized Terumo Distributors. Distributors should call Customer Administration for all questions related to orders and invoices: 800.888.3786

### What is the shelf life of Terumo Syringes?

Standard & Safety Syringes & Needles = 5 years  
Standard Insulin & Allergy Syringes = 5 years  
Injection Plugs = 2.5 years

### I'm looking for a 6cc, 12cc, 25cc and a 35cc syringe.

#### Does Terumo make these?

Our syringes are labeled nominally as 5, 10, 20, and 30cc. However, they have scale markings to 6, 12, 25, and 35cc, respectively.

### What's the difference between SurFlash® & Surflo® IV Catheters?

SurFlash is an I.V. Polyurethane Catheter which allows for a visual confirmation of catheter placement due to its unique flashback feature. SURFLO is our regular Teflon I.V. Catheter. Both are radio-opaque as well as Latex and DEHP Free.

### Are all your Winged Needle sets Latex free and DEHP free?

Yes, All Surshield® Safety Winged Needle Sets and SURFLO® Winged Infusion Sets are both DEHP and Latex Free.

### Where can I get a Certificate of Analysis on products I have ordered?

Visit us at <http://www.terumomedical.com/Default.asp?dest=Certification/MainCertMenu.asp>, choose your product category and enter your lot number and receive a Certificate of Analysis.

### Where can I get a copy of the MSDS for Capiject®?

Visit us at [www.TerumoTMP.com/Support](http://www.TerumoTMP.com/Support) to obtain documentation for MSDS.

### Which Capiject® tubes are certified for lead testing?

Visit us at [www.TerumoTMP.com/Support](http://www.TerumoTMP.com/Support) to obtain documentation related to Lead Certification.

### How do I find out about Elemano™?

Contact your local distributor representative.

**[www.TerumoTMP.com](http://www.TerumoTMP.com)**